

105,000sf B.T.S.

Project Data

Lot Area:	+/-8.0 ac (+348,480 sf)
Building Area :	105,000 sf
Coverage:	0.30
Parking :	248 spaces (2.36/1000)
Office (6000sf) :	24 spaces (4/1000)
Warehouse (99,000sf):	224 spaces (2.26/1000)
Lunch patio	3,800sf

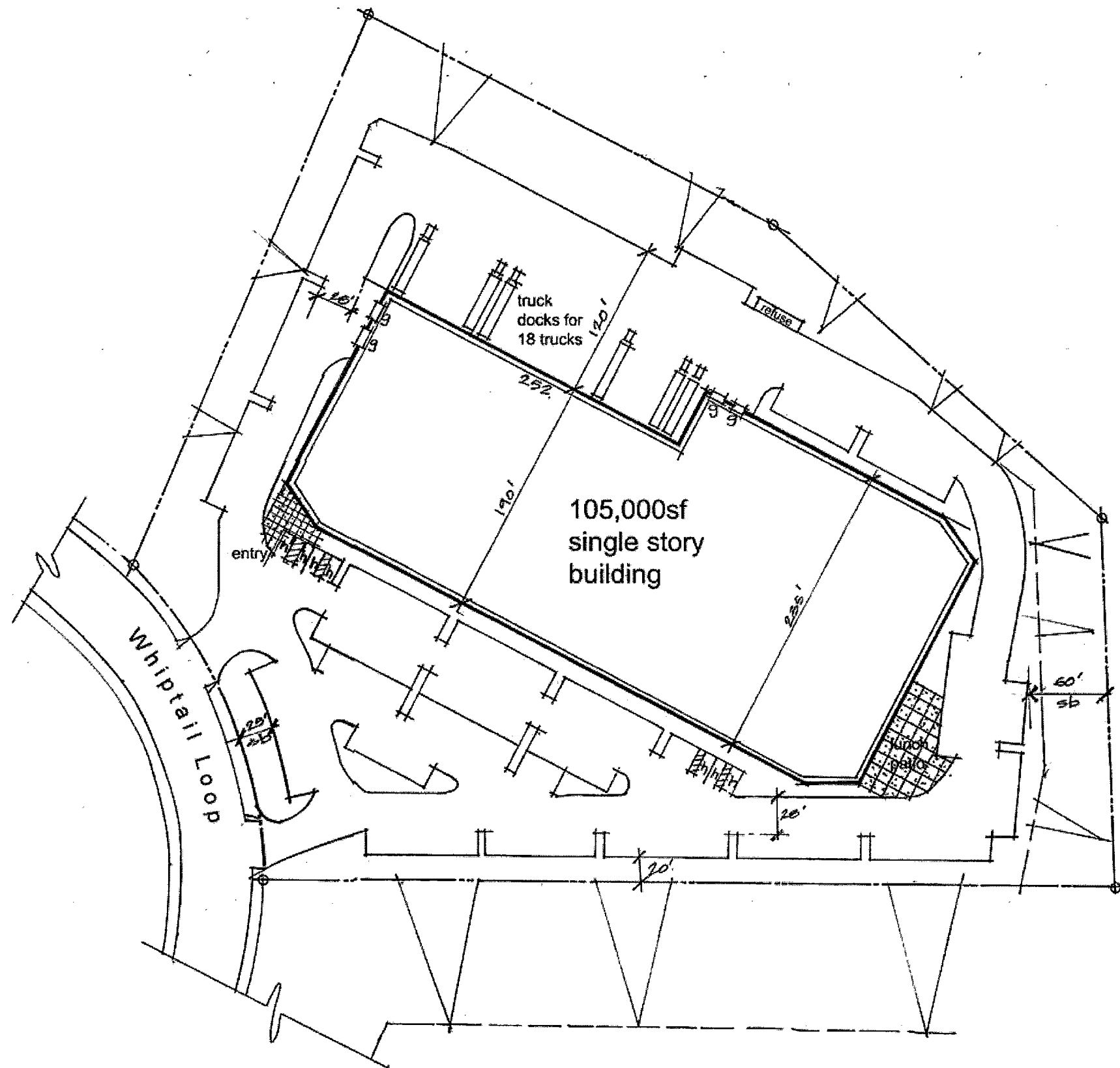

Lot 17 Carlsbad Oaks North
Techbilt Companies

Preliminary Site Plan

This is a conceptual site plan intended to explore one potential site development option, based on unverified and possibly incomplete property information. The design is based on a preliminary appraisal of entitlement requirements, and may not be used as the basis for any contractual or other binding purpose. Geotechnical, civil, and governmental requirements must be thoroughly reviewed and satisfied. Smith Consulting Architects makes no guarantee of the accuracy of and is not responsible for the unauthorized use of this plan.

Smith Consulting Architects

12220 El Camino Real, Suite 200 (858) 793 - 4777
San Diego, CA. 92130 Fax (858) 793 - 4787
08171 DATE: 08.12.08