

FOR LEASE > INDUSTRIAL SUITE

Poway Corporate Center



11870 COMMUNITY ROAD, SUITE 225, POWAY, CA 92064



The Building

- > Approximately 5,667 SF
- > Minimum 28' clear height
- > ESFR sprinklers
- > 50' x 56' column spacing
- > (2) Dock-high and (1) grade-level loading door

The Property

- > Zoned IP - City of Poway
- > Concrete paving throughout
- > Part of a 145,685 SF industrial/warehouse project

Access

- > Located at the end of Community Road on a private cul-de-sac
- > Exceptional visibility to Community Road
- > Easy access to I-15 via Scripps Poway Parkway and Poway Road and to Highway 67 via Scripps Poway Parkway

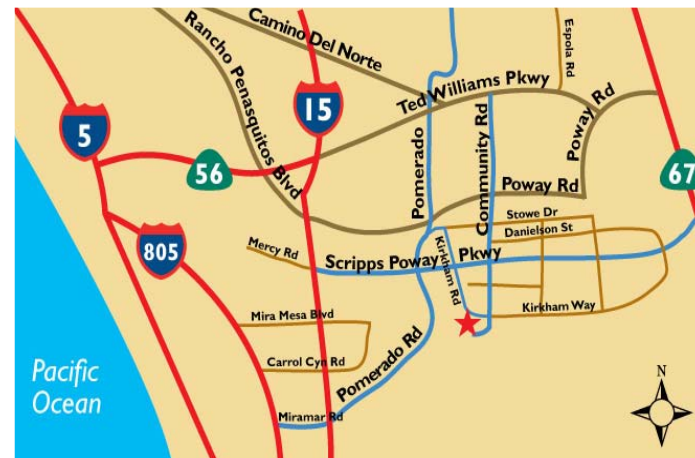

LEASE RATE: NEGOTIABLE

Operating expenses estimated at \$0.23/SF month

TED CUTHBERT
Senior Vice President
858 636 7988
CARLSBAD, CA
ted.cuthbert@colliers.com
Lic# 00964042

COLLIERS INTERNATIONAL
5901 Priestly Drive, Suite 100
Carlsbad, CA 92008
www.colliers.com/carlsbad

11870 Community Road, Suites 225 > Floor Plan

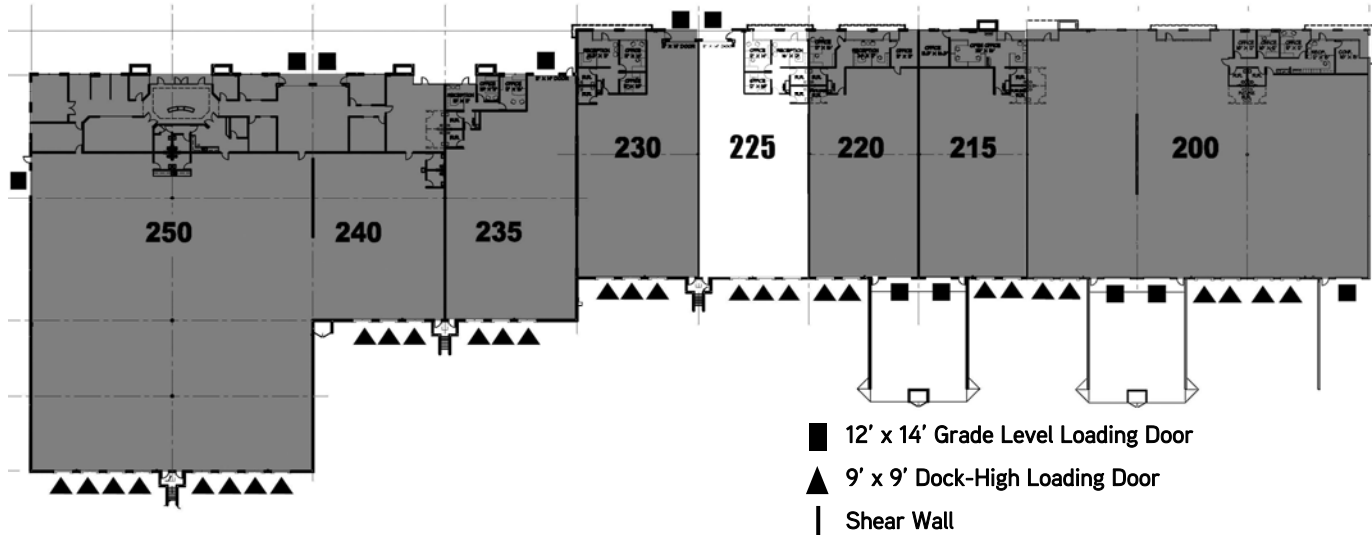

AVAILABILITY						
Suite #	Sq. Ft.	Columns	Loading	Power	Build-Out	Rental Rate
225	5,667	50' x 56'	1 - 12' x 14' Grade Level, 3 - 9' x 9' Dock-High Doors	200 Amps of 277/480 Volts	Approx. 933 SF: reception, 2 offices, 2 R/R	Negotiable

FLOOR PLAN

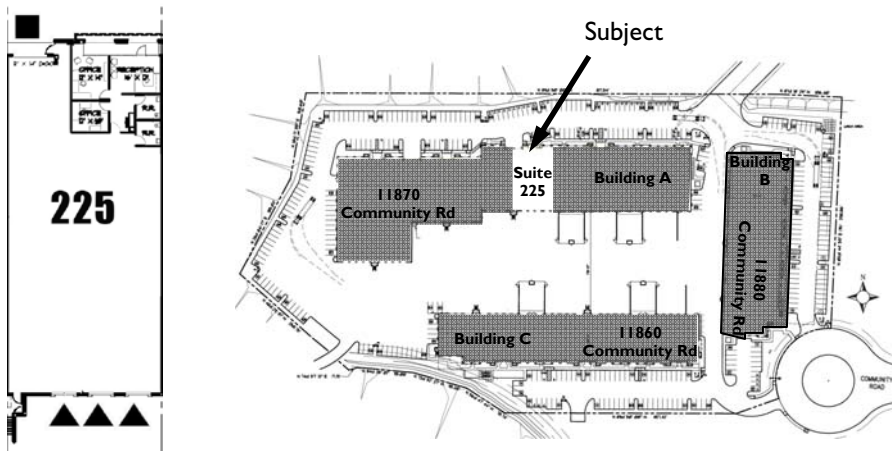

Contact Us

TED CUTHBERT
 Senior Vice President
 858 636 7988
 CARLSBAD, CA
ted.cuthbert@colliers.com
 Lic# 00964042

COLLIERS INTERNATIONAL
 5901 Priestly Drive, Suite 100
 Carlsbad, CA 92008
www.colliers.com/carlsbad

This document has been prepared by Colliers International for advertising and general information only. Colliers International makes no guarantees, representations or warranties of any kind, expressed or implied, regarding the information including, but not limited to, warranties of content, accuracy and reliability. Any interested party should undertake their own inquiries as to the accuracy of the information. Colliers International excludes unequivocally all inferred or implied terms, conditions and warranties arising out of this document and excludes all liability for loss and damages arising there from. Colliers International is a worldwide affiliation of independently owned and operated companies.

